

GRAPHIC DEVELOPMENT MMD	
Product name	XX5C7-QSG
Project name	XX5C7-QSG
Project no.	
Finishing	Folded sheet
Scale	1:1
Size Spreads	594 (W) x 210 (H) mm
Size	148.5 (W) x 210 (H) mm
Operator(s)	
Date amended	Jul. 14, 2016
VERSION No.	13
APPROVAL	
QC Lithographer	
Product Manager	
Date Check	
ARTWORK DOCUMENT	
Paper	80gsm White, woodfree coated
Numbers of colours	2C2C
Spotcolor	
Aftertreatment	
<input type="checkbox"/> Cropping	
<input type="checkbox"/> Coating	
<input type="checkbox"/> Varnishing	
<input type="checkbox"/> Embossing	
<input type="checkbox"/> Cutterguide	
<input type="checkbox"/> Die-cut	
<input type="checkbox"/> Binding	
<input type="checkbox"/> Glue	

4

245C7, 275C7

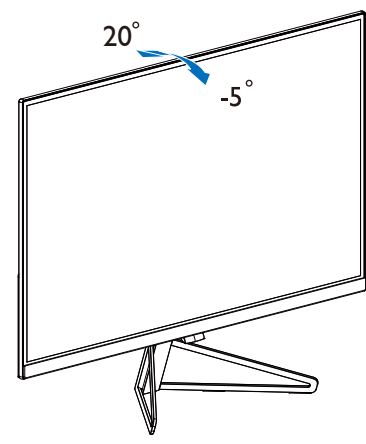

325C7

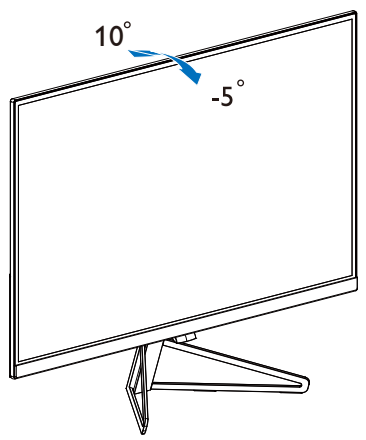

EN Need help?

Online help: www.philips.com/support

SC 需要帮助?

在线帮助: www.philips.com/support

FR Besoin d'Aide ?
Aide en ligne: www.philips.com/support

UA Потребуйте допомоги!
Підтримка он-лайн: www.philips.com/support

ES ¿Necesita ayuda?
Ayuda en línea: www.philips.com/support

RU Нужна помощь?
Интерактивная справка:
www.philips.com/support

DE Benötigen Sie Hilfe?
Online-Hilfe: www.philips.com/support

TR Yardıma ihtiyacınız var mı?
Online yardım: www.philips.com/support

IT Avete bisogno di aiuto?
Guida in linea: www.philips.com/support

HI क्या सहायता की जरूरत है?
ऑनलाईन सहायता: www.philips.com/support

BR Precisa ajuda?
Ajuda online: www.philips.com/support

AR هل تريد المساعدة؟
www.philips.com/support للمساعدة عبر الإنترنت

KO 도움이 필요하신가요?
온라인 도움말: www.philips.com/support

JP ヘルプが必要ですか?
オンラインヘルプ: www.philips.com/support

Version: M7XX5CQIT

© 2016 Koninklijke Philips N.V. All rights reserved. Specifications are subject to change without notice. Philips and the Philips Shield Emblem are registered trademarks of Koninklijke Philips N.V. and are used under license from Koninklijke Philips N.V.

www.philips.com



Register your product and get support at
www.philips.com/welcome

245C7
275C7
325C7



Quick Start

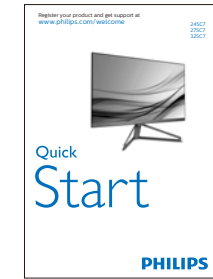
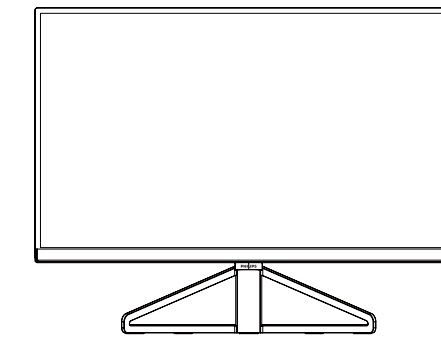

* CD

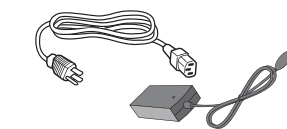

AC/DC Adapter

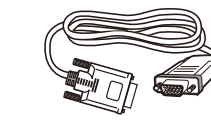

* VGA

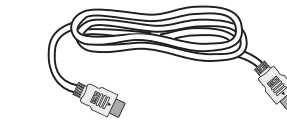

* HDMI

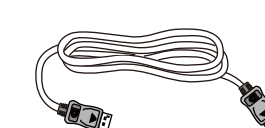

* DP

*Different according to region
Display design may differ from that illustrated

1

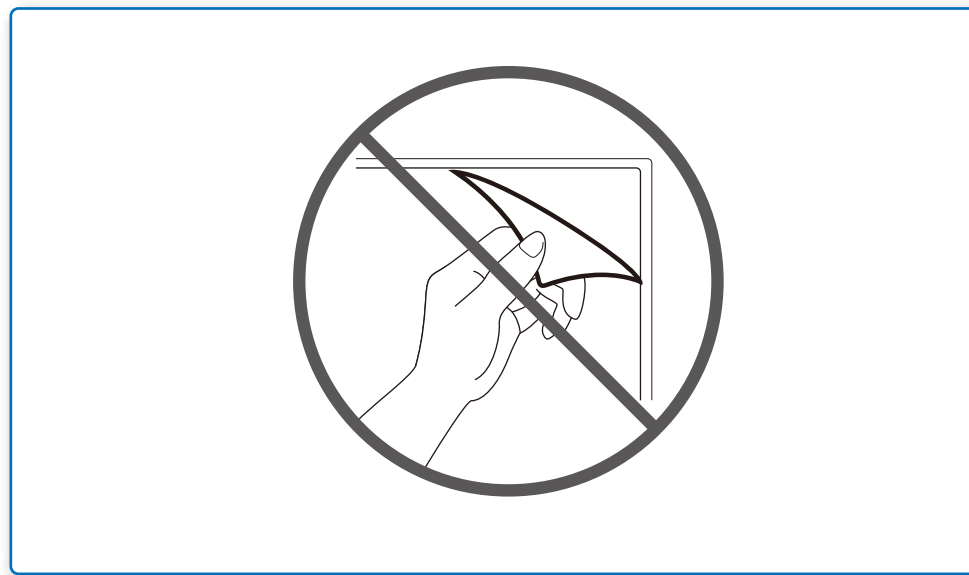

2

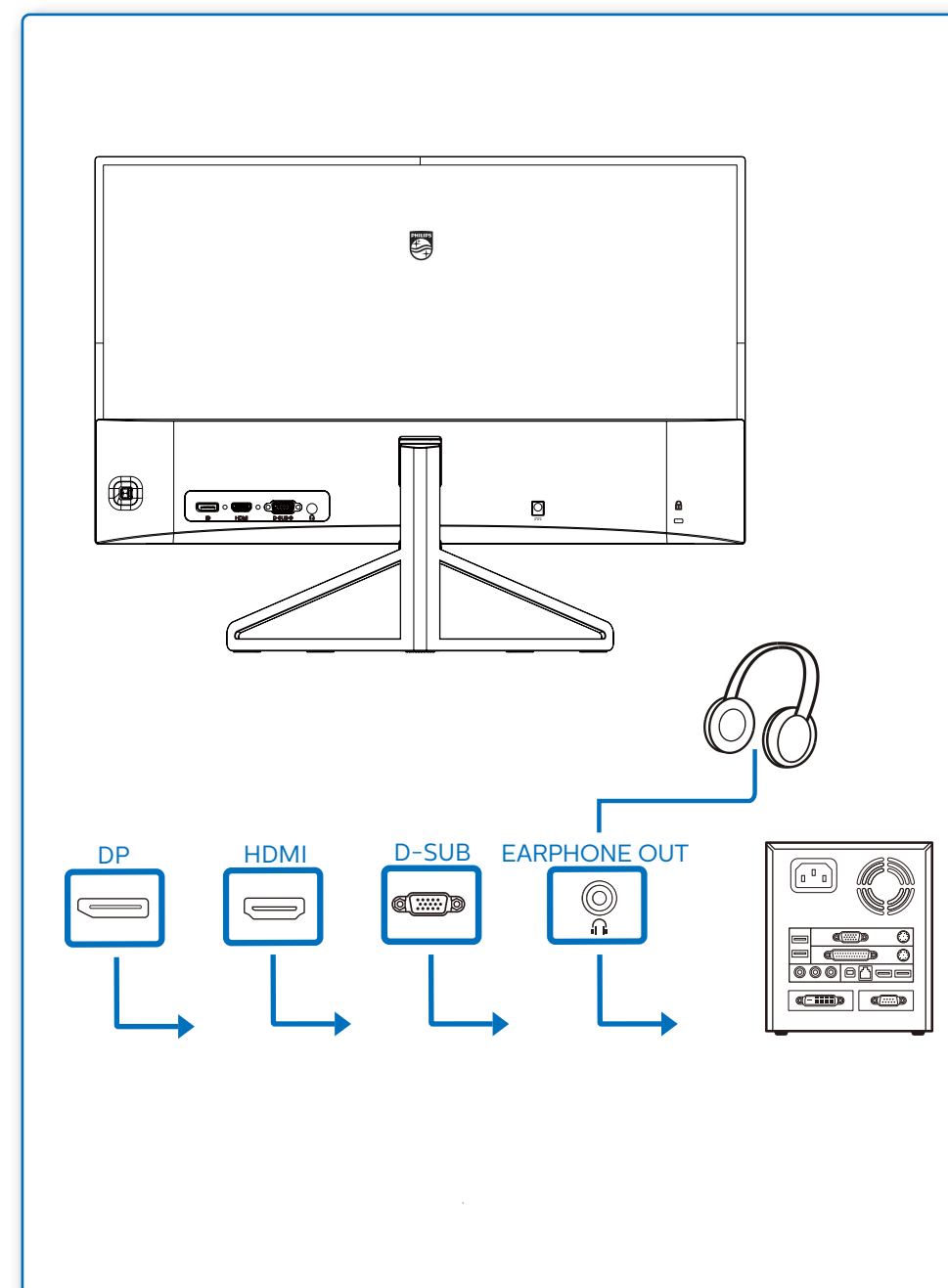
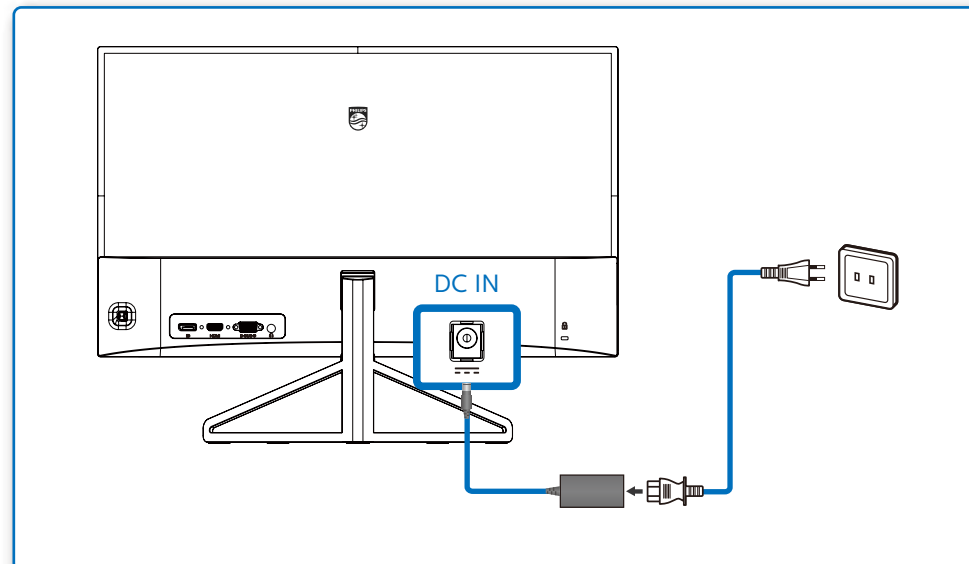

3

