



LCD monitor with PowerSensor

- B Line
- 25" (63.4 cm)
- WUXGA (1920 x 1200)

252B9/27

Clear vision, beyond boundaries

Expand beyond boundaries with the new 16:10 frameless design Philips B Line monitor. Loaded with features to improve productivity and sustainability, this monitor takes it to the next level.

Benefits

Designed for sustainability

- PowerSensor saves up to 80% energy costs
- Zero power consumption with 0 watt hard switch
- 100% Recycled packing material

Excellent performance

- IPS technology for full colors and wide viewing angles
- 16:10 aspect ratio for more vertical screen height

Designed for the way you work

- SmartErgoBase enables people-friendly ergonomic adjustments
- VESA mount allows for the perfect setup
- Less eye fatigue with Flicker-free technology
- LowBlue Mode for easy on-the-eyes productivity
- EasyRead mode for a paper-like reading experience

PHILIPS

Features

PowerSensor

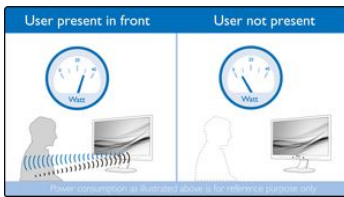

PowerSensor is a built-in 'people sensor' that transmits and receives harmless infrared signals to determine if user is present and automatically reduces monitor brightness when user steps away from the desk, cutting energy costs by up to 80 percent and prolonging monitor life

Zero power consumption

At the flick of the 0 watt hard switch which is conveniently located at the back, you can completely cut-off your monitor from AC power. This results in zero power consumption reducing your carbon footprint even further

IPS technology



IPS displays use an advanced technology which gives you extra wide viewing angles of 178/178 degree, making it possible to view the display from almost any angle - even in 90 degree Pivot mode! Unlike standard TN panels, IPS displays gives you remarkably crisp images with vivid colors, making it ideal not only for Photos, movies and web browsing, but also for professional applications which demand color accuracy and consistent brightness at all times.

SmartErgoBase



The SmartErgoBase is a monitor base that delivers ergonomic display comfort and provides cable management. The base's people-friendly height, swivel, tilt

Specifications

Please note that this is a pre-sales leaflet. The contents of this leaflet reflect the best of our knowledge per date and country mentioned above. The contents of this leaflet are subject to change without notice. Philips does not accept any liability as to the contents of this leaflet.

Picture/Display

LCD panel type	IPS technology
Backlight type	W-LED system
Panel Size	25 inch / 63.4 cm
Display Screen	Anti-Glare, 3H, Haze 25%
Coating	
Effective viewing area	535.5 (H) x 338.8 (V)
Aspect ratio	16:10
Optimum resolution	1920 x 1200 @ 60Hz
Pixel Density	91 PPI
Response time (typical)	5 ms (Gray to Gray)*
Brightness	300 cd/m ²
Contrast ratio (typical)	1000:1
SmartContrast	50,000,000:1
Pixel pitch	0.279 x 0.282 mm
Viewing angle	178° (H) / 178° (V)

and rotation angle adjustments position the monitor for maximum comfort that can ease the physical strains of a long workday; cable management reduces cable clutter and keeps the workspace neat and professional.

VESA mount

VESA pattern guarantees compatibility hundreds of innovative mounting solutions.

Flicker-free technology



Due to the way brightness is controlled on LED-backlit screens, some users experience flicker on their screen which causes eye fatigue. Philips Flicker-free Technology applies a new solution to regulate brightness and reduce flicker for more comfortable viewing.

LowBlue Mode



Studies have shown that just as ultra-violet rays can cause eye damage, shortwave length blue light rays from LED displays can cause eye damage and affect vision over time. Developed for wellbeing, Philips LowBlue Mode setting uses a smart software technology to reduce harmful shortwave blue light.

EasyRead mode



Flicker-free	Yes
Picture enhancement	SmartImage
Color gamut (typical)	NTSC 90%*, sRGB 107.5%*
Display colors	16.7M
Scanning Frequency	30 - 96 kHz (H) / 48 - 76 Hz (V)
sRGB	Yes
EasyRead	Yes
LowBlue Mode	Yes

Connectivity

Signal Input	VGA (Analog) DVI-D (digital, HDCP) DisplayPort 1.2 HDMI 1.4
HDCP	HDCP 1.4 (HDMI/ DP)
Sync Input	Separate Sync Sync on Green

data subject to change
2018, December 30

USB:	USB 3.1 x 1 (upstream), USB 3.1 x 4 (downstream with 1 fast charge B.C 1.2)
Audio (In/Out)	PC audio-in Headphone out

Convenience

Built-in Speakers	2 W x 2
User convenience	SmartImage Input Brightness Menu Power On/Off
Control software	SmartControl
OSD Languages	Brazil Portuguese Czech Dutch English Finnish French German Greek Hungarian Italian Japanese Korean Polish Portuguese Russian Simplified Chinese Spanish Swedish Traditional Chinese Turkish Ukrainian
Other convenience	Kensington lock VESA mount (100x100mm)
Plug & Play Compatibility	DDC/CI Mac OS X sRGB Windows 10 / 8.1 / 8 / 7

Stand

Height adjustment	150 mm
Pivot	-/+ 90 degree
Swivel	-/+ 175 degree
Tilt	-5 ~ 30 degree

Power

ECO mode	12.3 W (typ.)
On mode	15 W (typ.) (EnergyStar 7.0 test method)
Standby mode	< 0.5 W (typ.)
Off mode	Zero watts with Zero switch
Power LED indicator	Operation - White Standby mode- White (blinking)
Power supply	Built-in 100-240VAC, 50-60Hz

Dimensions

Product with stand(max height)	546 x 541 x 206 mm
Product with stand(max height)	21.5 x 21.3 x 8.1 inch
Product without stand (mm)	546 x 367 x 49 mm
Product without stand in inch	21.5 x 14.4 x 1.9 inch
Packaging in mm (WxHxD)	608 x 524 x 197 mm

Packaging in inch (WxHxD)	23.9 x 20.6 x 7.8 inch
---------------------------	------------------------

Weight

Product with stand (kg)	5.09 kg
Product with stand (lb)	11.20 lb
Product without stand (kg)	3.50 kg
Product without stand (lb)	7.70 lb
Product with packaging (kg)	7.44 kg
Product with packaging (lb)	16.37 lb

Operating conditions

Temperature range (operation)	0°C to 40°C °C
Temperature range (storage)	-20°C to 60°C °C
Relative humidity	20%-80 %
Altitude	Operation: +12,000ft (3,658m), Non-operation: +40,000ft (12,192m)
MTBF (demonstrated)	70,000 hrs (excluded backlight)

Sustainability

Environmental and energy	PowerSensor EnergyStar 7.0 EPEAT* TCO certified WEEE RoHS
Recyclable packaging material	100 %
Post consumer recycled plastic	85%
Specific Substances	PVC / BFR free housing Mercury free Lead free

Compliance and standards

Regulatory Approvals	CE Mark FCC Class B SEMKO cETLus CU-EAC TUV Ergo TUV/GS EPA ICES-003
----------------------	--

Cabinet

Front bezel	Black
Rear cover	Black
Foot	Black
Finish	Texture

What's in the box?

Monitor with stand	Yes
Cables	D-Sub cable, HDMI cable, DP cable, USB-A to B cable, Audio cable, Power cable
User Documentation	Yes

- * "IPS" word mark / trademark and related patents on technologies belong to their respective owners.
- * Response time value equal to SmartResponse
- * NTSC Area based on CIE1976
- * sRGB Area based on CIE 1931
- * Fast charging complies with USB BC 1.2 standard
- * EPEAT Gold or Silver is valid only where Philips registers the product. Please visit www.epeat.net for registration status in your country.
- * The monitor may look different from feature images.



data subject to change
2018, December 30

Version: 1.0.1
UPC: 609585252417

© 2018 Koninklijke Philips N.V.
All rights reserved.

Specifications are subject to change without notice. Trademarks are the property of Koninklijke Philips N.V. or their respective owners.

www.philips.com